

FLX-TO-3 Package Drawing

(all dimensions in mm)

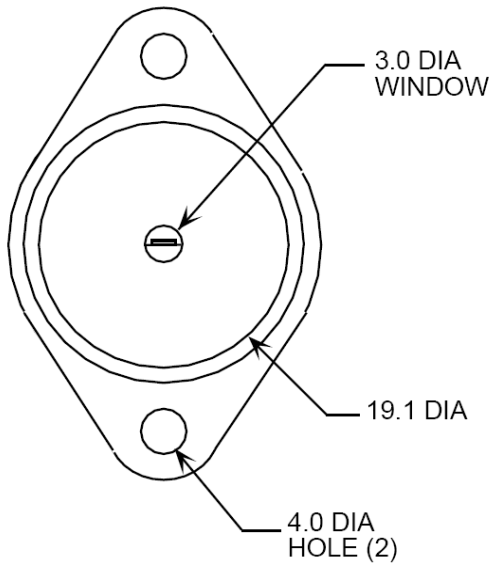
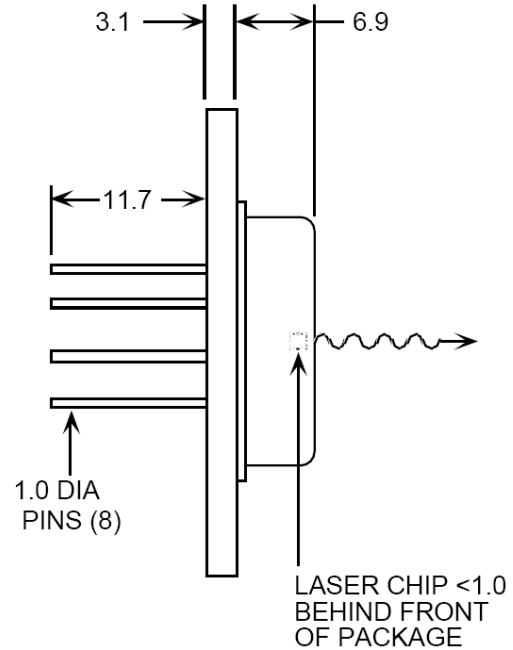
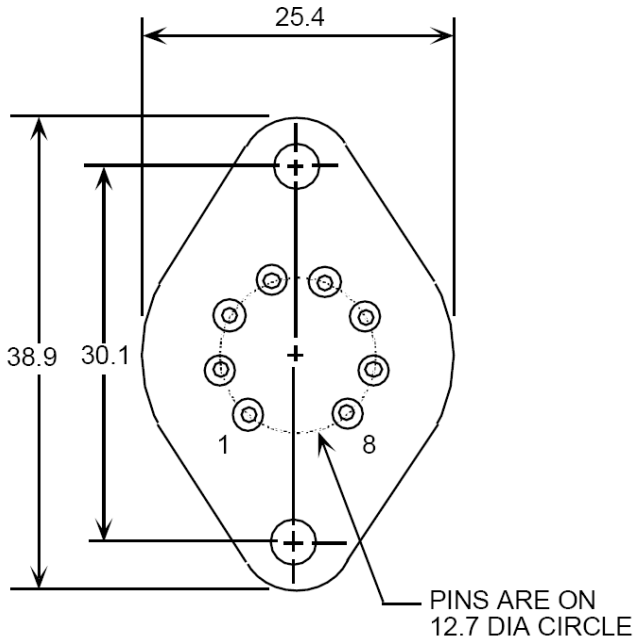

Thermoelectric cooler rated 6.2 V, 1.8 A maximum.

Thermistor constants: A= 1.129E-3, B= 2.341 E-4, C= 0.878 E-7

Thermistor resistance: 10.0 KΩ @ 25°C, 12.5 KΩ @ 20°C, 15.7 KΩ @ 15°C, 19.9 KΩ @ 10°C, 25.4 KΩ @ 5°C, 32.7 KΩ @ 0°C, 42.3 KΩ @ -5°C, 55.3 KΩ @ -10°C

Pin Out	
1 TEC (+)	5 Laser Anode (+)
2 Thermistor	6 Photodiode Anode (-)
3 Thermistor	7 Photodiode Cathode (+)
4 Laser Cathode (-)	8 TEC(-)