



# FBLD-976-10-FC-HHL-GREEN

## Fiber-coupled High Power Laser Diode with Green Aiming Beam

<b>Optical data</b>	
Output power	10 W CW at the fiber end
Center wavelength $\lambda$	976 nm
Tolerance of $\lambda$	$\pm 3, \pm 10$ nm
Spectral width (FWHM)	<3 nm
Temperature drift of $\lambda$	0.3 nm/°C
<b>Electrical data</b>	
Threshold current	0.5 A
Operation current	12 A
Efficiency	35 - 45 %
Slope efficiency	0.8 – 1.0 W/A
Operation voltage	1.9 V
Reverse voltage	2 V
<b>Temperature conditions</b>	
Case operation temperature	+10 ~ +30°C
Storage temperature	-20 ~ +80°C
<b>PD Data</b>	
Current	0.2 ~ 2.0 mA
<b>TEC Data</b>	
Max. Current	6.0 A
Max. Voltage	9.8 V
<b>Thermistor Data</b>	
Thermistor	$10 \pm 0.5 / 3477 (K\Omega) \beta (25^\circ C)$

<b>Fiber data</b>	
Core diameter	200 $\mu\text{m}$
N.A.	0.22
Connector	SMA-905
<b>Aiming Beam data</b>	
Output power	> 2 mW
Wavelength	520 nm
Voltage	7.3 V
Current	< 100 mA
<b>Other parameters</b>	
Expected lifetime (MTBF)	> 10000 h
Laser head dimensions (Fiber and connector not included)	44.5 x 31.8 x 18.0 mm
Lead soldering temperature	260°C (10 sec.)

## Typ. Spectrum (T=25°C)

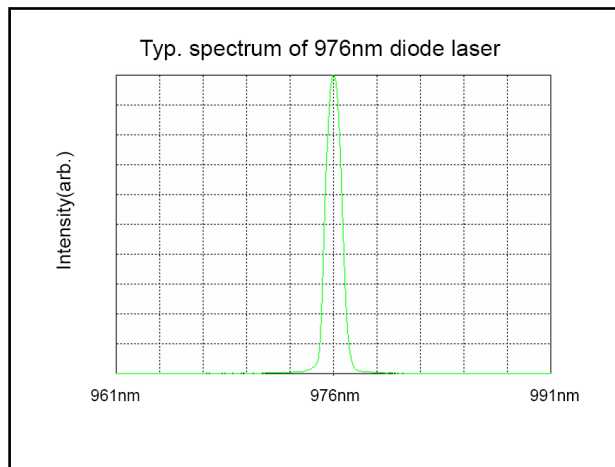

## Package Dimensions (mm)

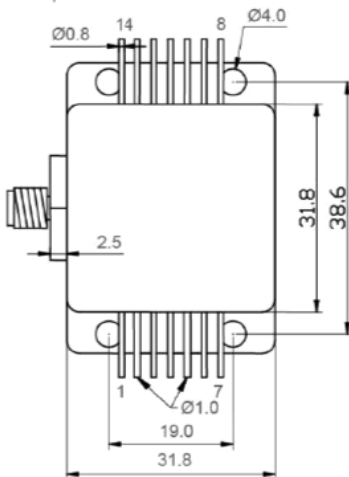
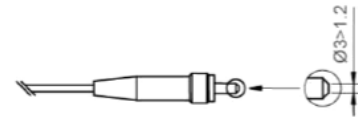
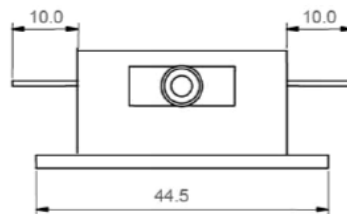
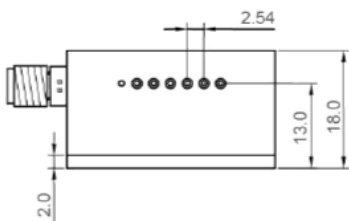
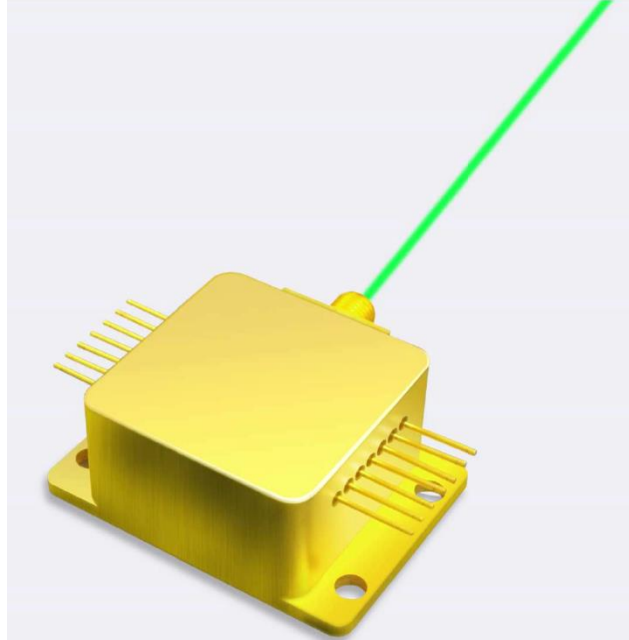

Pin	Function	Pin	Function
1	Case	8	TEC (-)
2	LD (+)	9	FCD PD (P)
3	Thermistor	10	FCD LED (-)
4	Thermistor	11	FCD LED (+), FCD PD (N)
5	LD (-)	12	Aiming Beam LD (+)
6	PD (P)	13	Aiming Beam LD (-)
7	PD (N)	14	TEC (+)